

SPECIFICATION FOR APPROVAL

Material

Production:	Iron Powder Cores
FUAN.P/N:	KT224-52C
AL:	155(nH/N ²)(±10%)
Material:	-52
Coating Color:	Green/Blue
Coating material:	epoxy
Coating Breakdown Voltage:	800V, 0.5mA, 2Sec

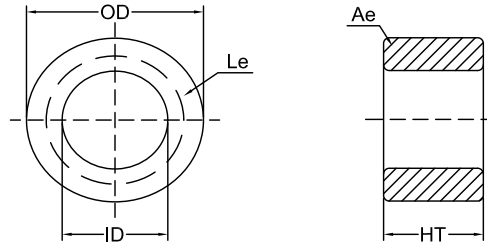

Physical Characteristics

After Coating			Le(cm)	Ae(cm ²)	V(cm ³)	W(cm ²)	Weight (g) (ref.)	Box Quantity (Pieces)
OD mm	ID mm	Ht mm						
57.2±0.63	31.8±0.63	19.1±0.75	14.000	2.310	32.200	2.864	229.91	80

Electrical Parameters(Typical) Temperature(25°C±2°C)

Test Item	Test Condition	Value(Typical)	Test Instrument
Inductance	φ0.29mm/10Ts, 10kHz/1V, I=0A (Evenly full windings)	15.5μH(±10%)	CH3302
DC-Bias	φ0.50mm/80Ts,10kHz/1V,L(7.0A)/L(0A)*100%(H=50Oe) (Evenly full windings)	53%(Min.)	WK3255B+WK3265B
Core Loss	100KHz/140Gs	67mW/cm ³ (Max.)	SY-8219
Q	φ0.50mm/80Ts, 200kHz/1V, I=0A (Evenly full windings)	16.0(Min.)	CH3302
Remarks	Set the internal resistance of LCR meter to 100Ω.		

DC-Bias Curves(Typical)

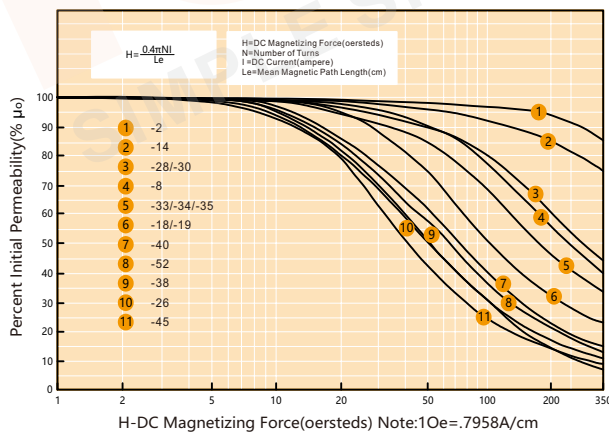

Core Loss Curves(Typical)

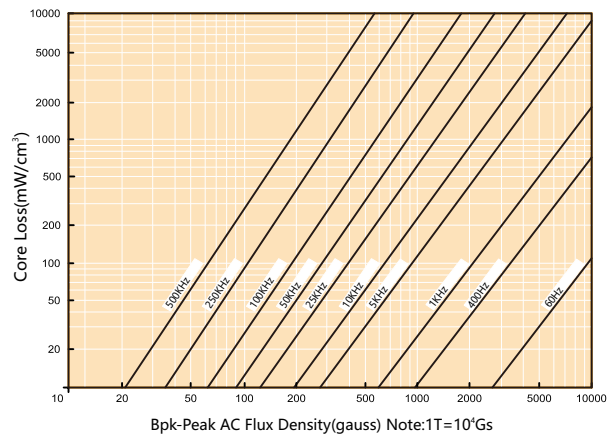

Iron Powder Cores is a magnetic core which use traditional production arts, after the pure powder which content of Fe is more than 99% surface insulation coating and then mixed pressed with organic binder. Because it hasn't been conducted in the high temperature, so it's used temperature is -65C ~ +125C. Products including permeability 10ui-100ui, toroid, E type,