

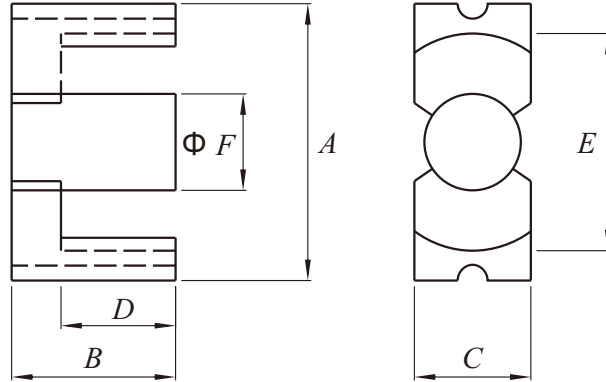

Dimension: (UNIT: mm)

A	71.7MAX
B	34.5 ± 0.15
C	16.4 ± 0.4
D	22.75 ± 0.45
E	43.3Min
F	16.4 ± 0.4
G	
H	



Test conditions

AL: F=1.0KHZ U=0.3V N=10Ts

Effective parameter

C1(mm) <sup>3</sup>	Ae(mm)	Le(mm <sup>2</sup> )	Ve(mm <sup>3</sup> )	Weight(g)
0.514	279	144	40100	≈ 127



Core halves

AL measured in combination with an non-gapped core half, unless otherwise stated.

Grade	Grade	μe	AIRGAP μe	Type number
P3	250±3%	≈ 102	≈ 1830	EC 70-P3
	315 ± 3%	≈ 130	≈ 1370	EC 70-P3
	400 ± 3%	≈ 165	≈ 1020	EC 70-P3
	630 ± 5%	≈ 256	≈ 580	EC 70-P3
	1000 ± 10%	≈ 406	≈ 320	EC 70-P3
	3900 ± 25%	≈ 1580	≈ 0	EC 70-P3

Properties of core sets under power conditions

Grade	B (mT)at	Core loss (w) at	
	H=250 A/m F=25KHz T=100℃	f=25 KHz B=200mT T=100℃	f=100 KHz B=100mT T=100℃
P3	≥330	≤4.9	≤5.1

Note

- 1:Document is the property of FUAN Inc & is not allow to be duplicated without authorization
- 2:RoHS compliant.